

# In-Line Manual Models to Circulating Conversion

December 2024 v1.0

/ User Manual

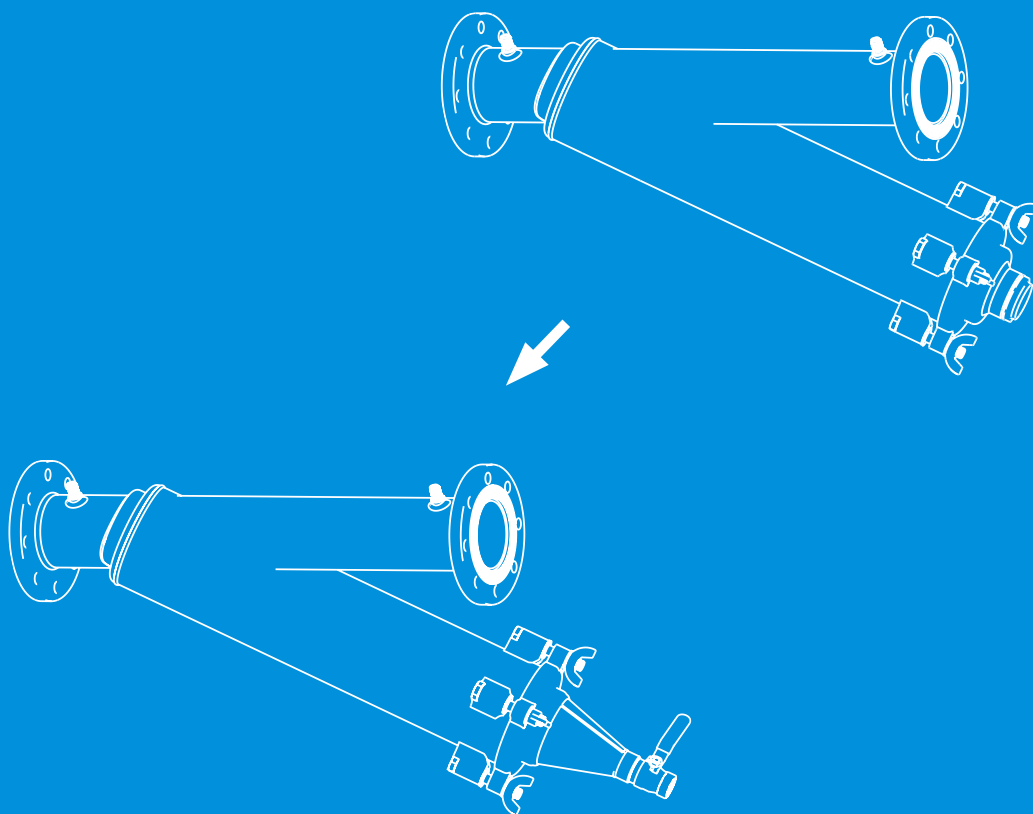

# / Conversion Kits

## → Catalog Numbers

Description	Catalog Number
KIT UPGRADE 1 1/2"-4" I/L TO CIR. FIL.	71985-000385
KIT UPGRADE 6"-8" I/L TO CIR. FIL.	71985-000386

## → Conversion Kit Parts

#	Description
F	Rotor Bolt
G	Rotor
H	Disc
B	Cover
L	Valve

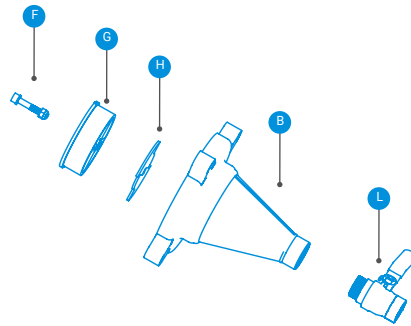

# / Conversion - Step by Step

## → Disassembly

1. Close the water inlet valve and drain the filter. Make sure the filter is not under pressure before operation
2. Open Bolts **(C)**, remove filter cover **(P)**, gasket **(S)** and screen element **(D)**
3. For 1.5"-4" filters open the last segment clamp **(M)** of the screen element **(D)** and pull out the last element **(N)**.  
For 6"-8" filters disassemble the PVC ring **(O)** by opening the 5 screws around

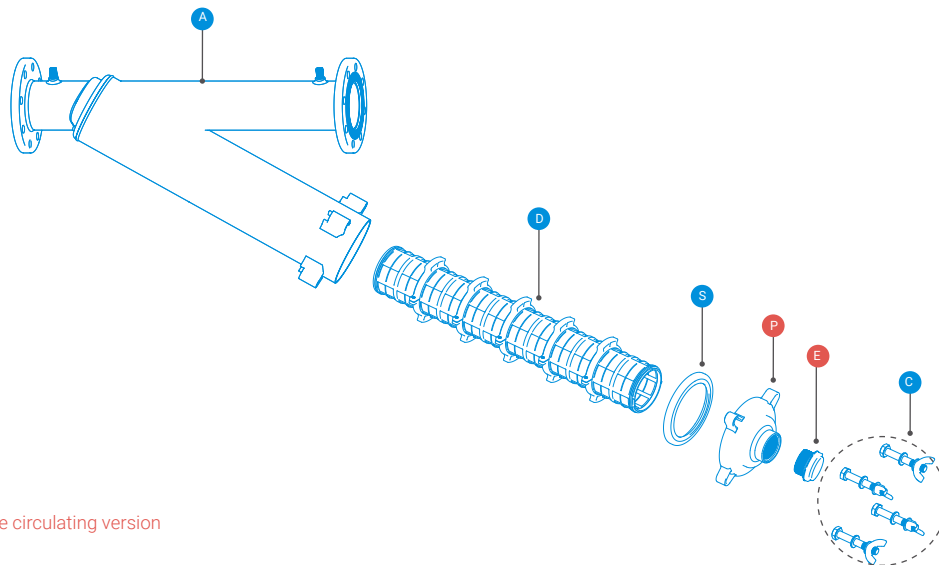

\* Parts not needed for the circulating version

### Disassembly 1.5" - 4"

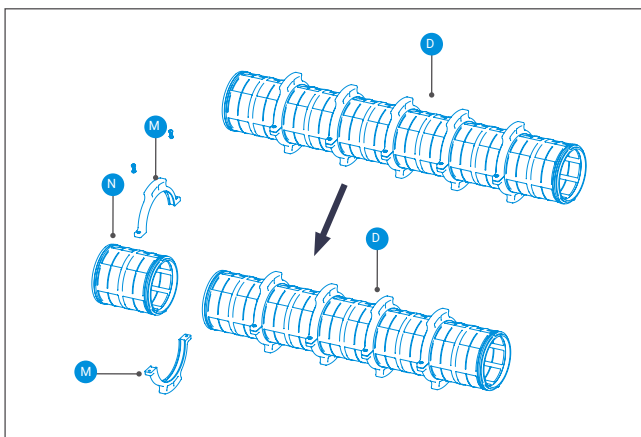

### Disassembly 6" - 8"

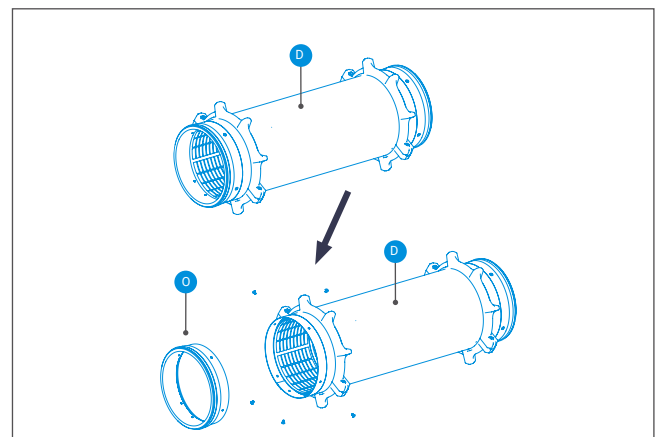

## → Assembly

1. Place the rotor (**G**) and push tight into the inner side of the filter screen segment (**N**).  
Place the required disc (**H**) from the inside of the segment and secure both using the bolt (**F**) then the segment (**N**) should be reattached to the element (**D**) and the clamp (**M**) should be re installed at the same position.  
\* On 6" / 8" filter simply locate the rotor where the PVC ring (**O**) was located after inserting the required disc (**H**) and securing it with the bolt (**F**) to the rotor (**G**) same screws of the pvc ring (**O**) should be used to fasten the rotor on the screen element (**D**)
2. When both parts assembled install the screen element back into the filter body (**A**), while the rotor is on the inner side
3. Place the Cover (**B**) and gasket (**S**) back on the filter body and secure the bolts tight (**C**)
4. Install the valve (**L**) on the cover (**B**) socket

\* The conversion is only valid for v.2 manual metal ScreenGuard

Disassembly 1.5" - 4"

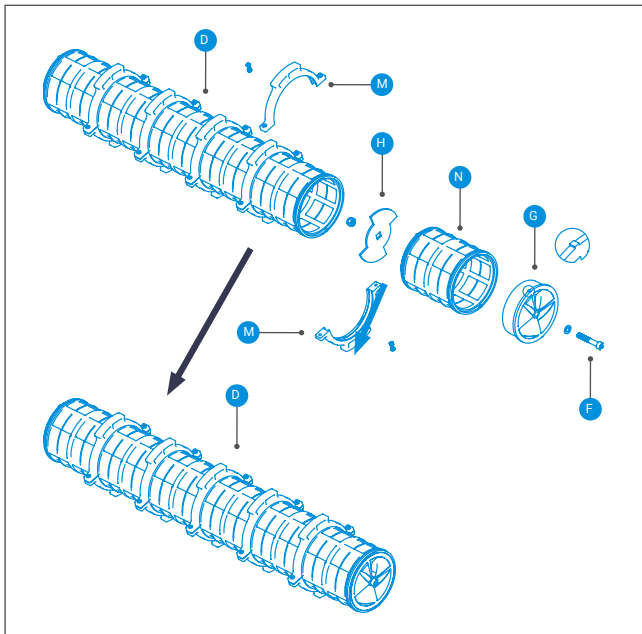

Disassembly 6" - 8"

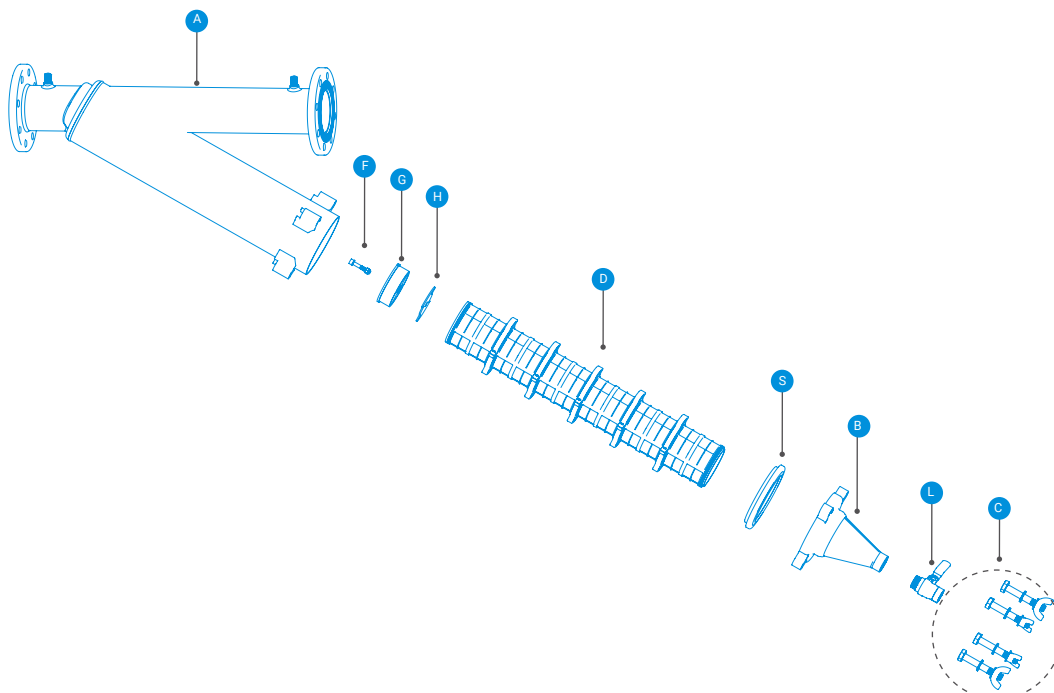
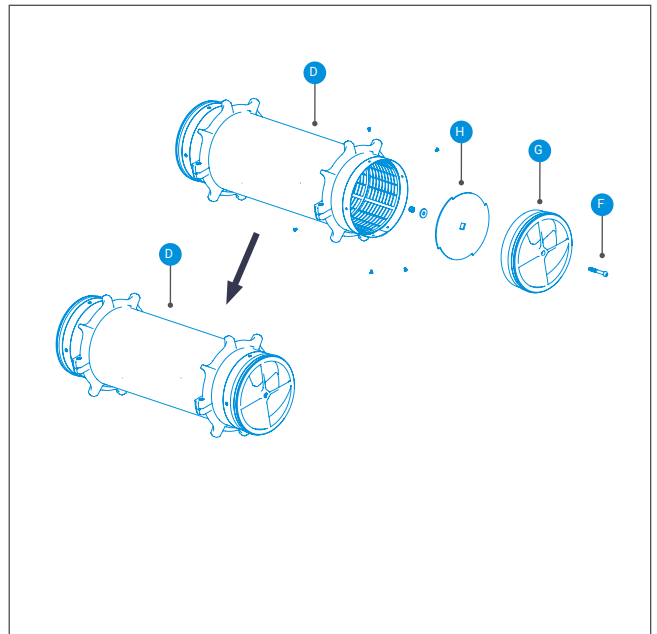



04-1024-FLI-L DM-0003-EN



[www.netafim.com](http://www.netafim.com)